

Powder Room Details

Silver Lakes Ranch
 Building Lot 551
 Crosstimbers Dr
 Bowie, TX 76230



**PRELIMINARY
NOT FOR CONSTRUCTION**

NOT APPROVED: _____
 APPROVED FOR CONCEPT: _____
 APPROVED FOR PRODUCTION: _____
 APPROVED WITH NOTED CHANGES: _____

THE REQUEST FOR APPROVAL OF THESE DRAWINGS HAS BEEN NOTED ABOVE WITH ALL APPROPRIATE LINES CHECKED. I UNDERSTAND THAT THIS STRUCTURE IS TO BE ASSEMBLED IN ACCORDANCE WITH THE DETAILS PROVIDED IN THE PREMIER BUILDING SYSTEM "CONSTRUCTION MANUAL". I HAVE HAD ALL APPROPRIATE ADVISORS INCLUDING; GENERAL CONTRACTORS, SAID ARCHITECTS, OR ANOTHER THIRD PARTY, REVIEW THESE DRAWINGS.
 SIGNATURE OF OWNER/CONTRACTOR: _____
 DATE: _____

DEFINITIONS

OWNER/CONTRACTOR: Mr. & Mrs. Frank Brown
 DISTRIBUTOR: GeoFaze SIPs

 SECTION VIEW INDICATOR

 Detail Title
 Scale

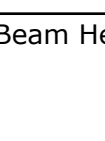
 Height
 Beam Height

 ELEVATION INDICATOR

STATISTICS

LOCATION	TYPE	PANEL THICKNESS	CORE THICKNESS	OSB THICKNESS	R-VALUE	SQUARE FOOTAGE
MAIN HOUSE	ROOF	10 1/4"	9 3/8"	7/16"	40	5,063
MAIN HOUSE	WALLS	6 1/2"	5 5/8"	7/16"	24	3,053
GARAGE	ROOF	10 1/4"	9 3/8"	7/16"	40	1,638
GARAGE	WALLS	6 1/2"	5 5/8"	7/16"	24	1,848
LOCATION	AC SQUARE FOOTAGE					
MAIN HOUSE						
GARAGE						

GeoFaze SIPs
Structural Insulated Panels™

GeoFaze SIPs
27 Glen Hill Road
Wilton, CT 06897

PROJECT
Powder Room Details
PROJECT ADDRESS
Silver Lakes Ranch
Building Lot 551
Crosstimbers Dr
Bowie, TX 76230

ISSUE
05.12.2021
RE-ISSUE

PROJECT NO.
21-101
CLIENT
Mr. & Mrs. Frank Brown
9013 Thompson Dr.
Argyle, TX 76226

DRAWN BY
TLH
DESCRIPTION
Cover Page



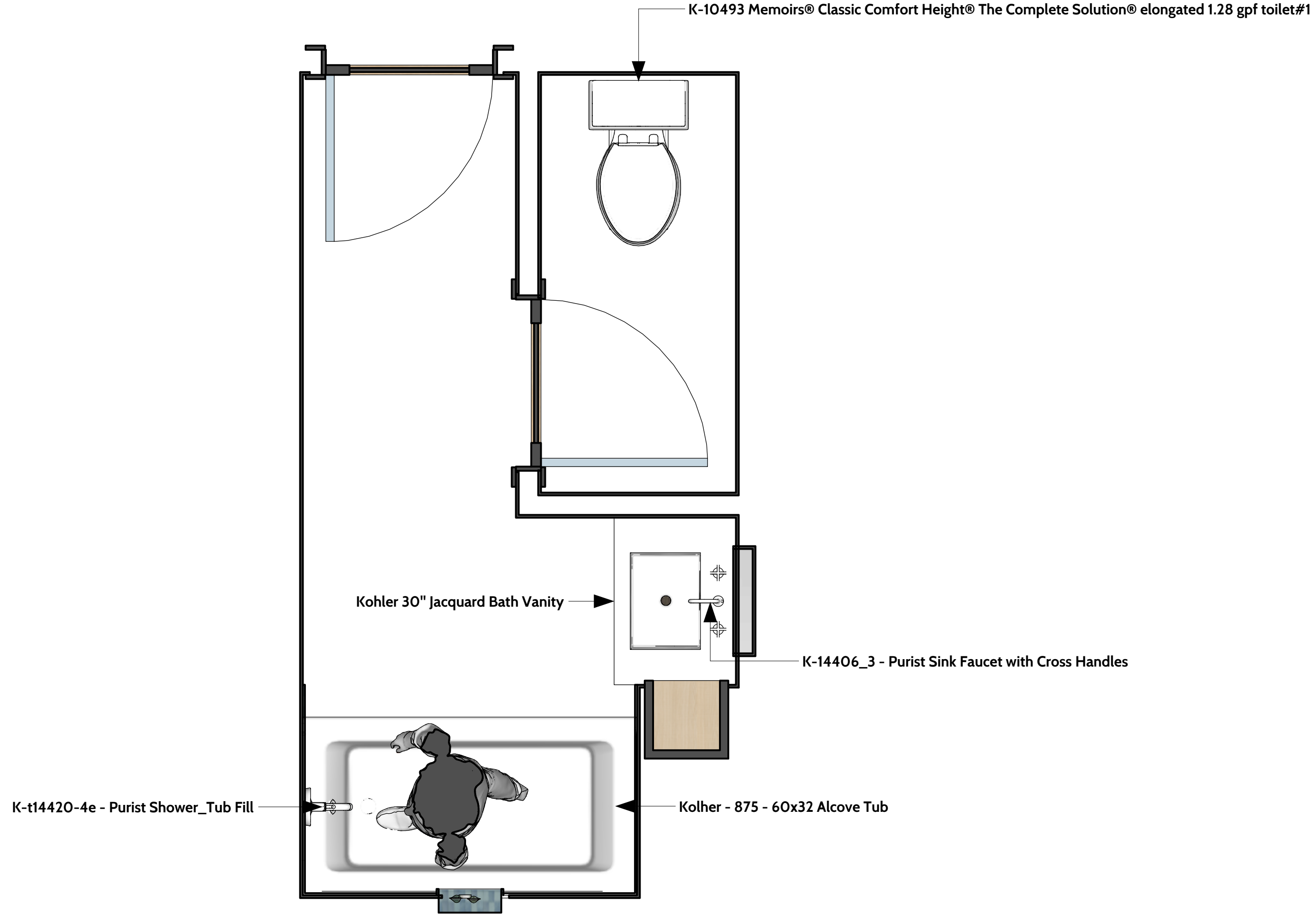

DRAWN BY
TLH

DESCRIPTION
Floor Plan

PROJECT NO.
21-101

CLIENT
Mr. & Mrs. Frank Brown
9013 Thompson Dr.
Argyle, TX 76226

ISSUE
05.12.2021

RE-ISSUE

PROJECT
Powder Room Details
PROJECT ADDRESS
Silver Lakes Ranch
Building Lot 551
Crossinbears Dr
Bowie, TX 76230

Geofaze SIPS
27 Glen Hill Road
Wilton, CT 06897

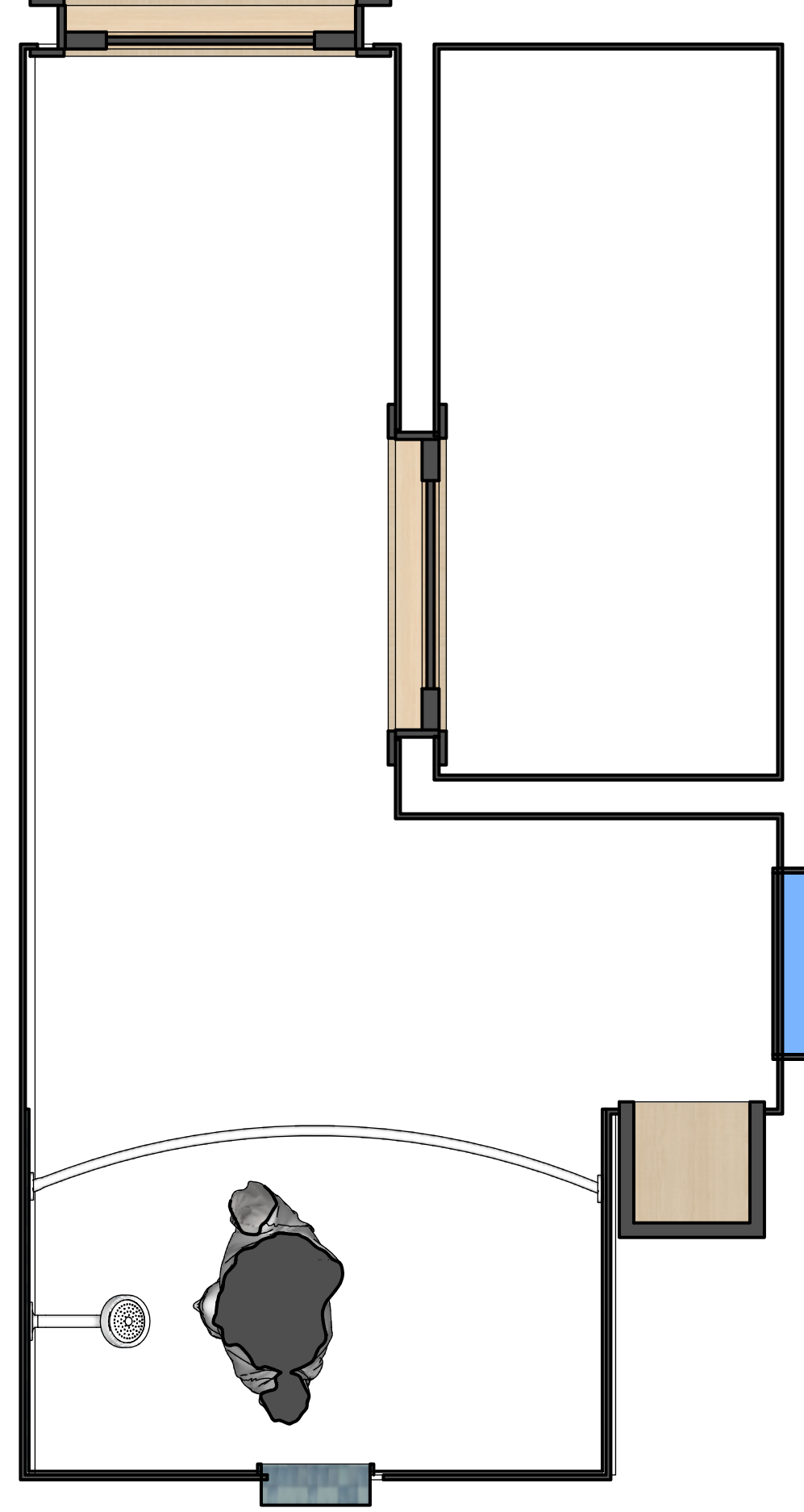

DRAWN BY
TLH

DESCRIPTION
Reflected Ceiling Plan

PROJECT NO.
21-101

CLIENT
Mr. & Mrs. Frank Brown
9013 Thompson Dr.
Argyle, TX 76226

ISSUE
05.12.2021

RE-ISSUE

PROJECT
Powder Room Details
PROJECT ADDRESS
Silver Lakes Ranch
Building Lot 551
Crossinbers Dr
Bowie, TX 76230

GeoFaze SIPS
27 Glen Hill Road
Wilton, CT 06897

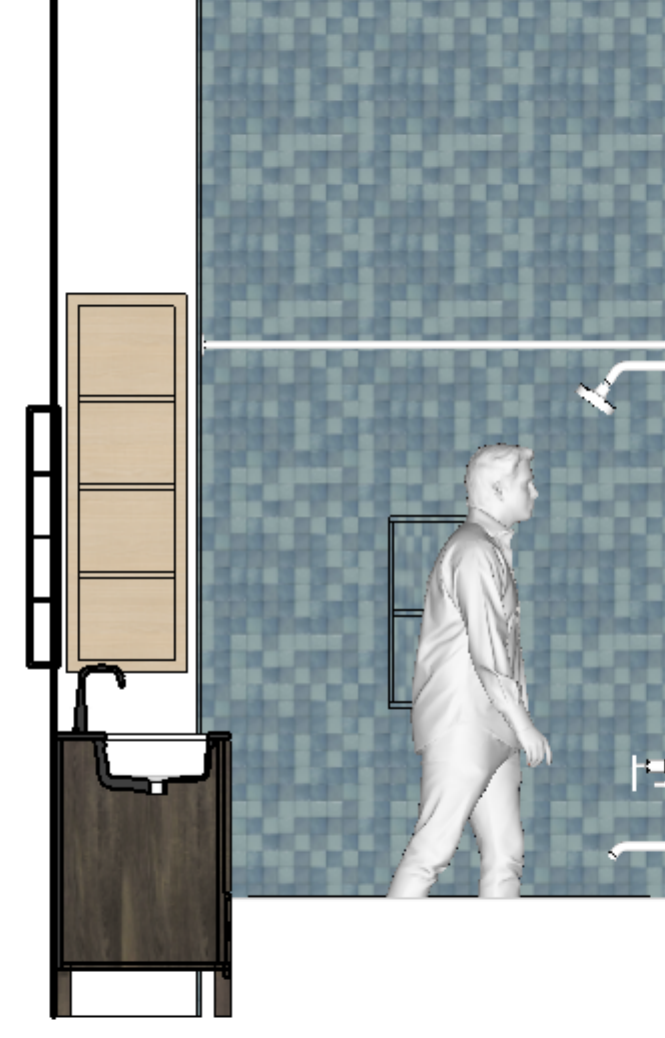
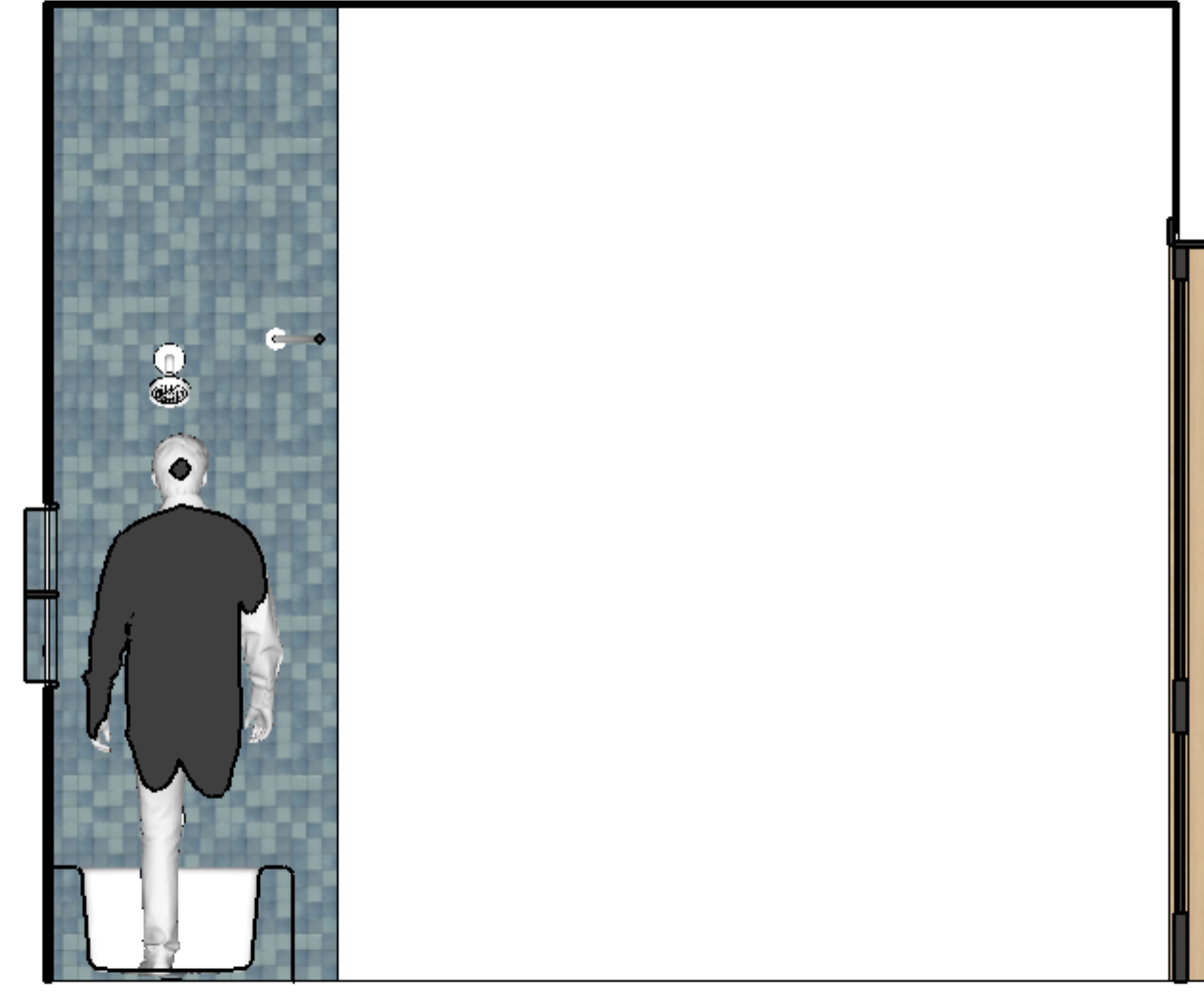

DRAWN BY
TLH

DESCRIPTION
Elevations

PROJECT NO.
21-101

CLIENT
Mr. & Mrs. Frank Brown
9013 Thompson Dr.
Argyle, TX 76226

ISSUE
05.12.2021

RE-ISSUE

PROJECT
Powder Room Details

PROJECT ADDRESS
Silver Lakes Ranch
Building Lot 551
Crosstimbers Dr
Bowtie, TX 76230

GeoFaze SIPS
27 Glen Hill Road
Wilton, CT 06897

GeoFaze SIPS
Structural Insulated Panels™